

Seeburg

SHOOT THE BEAR

RAY-O-LITE RIFLE RANGE

Model G4

TO PREPARE FOR OPERATION

DAMAGE CAUSED BY SHIPPING

Examine the instrument immediately after unboxing. If any damage is found, notify the transportation representative and obtain signature on the transportation bill with notation of damage.

TARGET CABINET

Remove packing that holds target figure and carriages. The rail assembly must float freely on its rubber cushions. Do not remove screws which hold rubber cushions to wood support.

TARGET CABINET LEGS

The Amplifier-Controller Unit should first be removed from cabinet to provide access to leg bolts on rear of cabinet. Target Cabinet can be laid on its back to facilitate assembling legs.

GUN STAND

The Gun Stand is shipped ready for operation and requires only careful unpacking.

CURRENT SUPPLY

A name plate, mounted on cabinet back, designates the type of current and voltage. The type of current at the location may be determined by examining the current meter name plate or by inquiring at the local electric company for information. Should the instrument be connected to a type of current or voltage other than that designated on the name plate, the electrical equipment in the instrument will be damaged.

INSTALLATION

TARGET CABINET

The Target Cabinet can be used with the legs as furnished, or may be fastened to the wall by means of 3 wall mounting brackets, Part No. 125668. Two brackets are to be fastened to the back of the cabinet at the top and one at the bottom. The cabinet is drilled for studs on sixteen inch centers. Do not fasten these brackets to the cabinet until the distance between wall studs has been determined. The wall studs are generally two-by-fours and are usually on sixteen inch centers. All necessary parts and hardware can be obtained by ordering "Wall Mounting Kit" No. 125687 from your Seeburg Distributor. If tile walls or metal lath are encountered, use toggle bolts which can be obtained at the local hardware store. The bracket at the bottom is to prevent the cabinet from being pulled away from the wall, tearing loose the top supports.

Caution: Be sure lag screws actually go into the wall studs and not just the plaster and lath. If insecurely fastened, cabinet may fall and damage both cabinet and wall.

VENTILATION

Insufficient cabinet ventilation may cause serious equipment damage and sound from the growler will be greatly reduced if the target is installed on a shelf or table. The cabinet bottom should be propped-up at least three inches (3") for proper clearance.

CONNECTIONS

The service cord is brought out through the opening provided for it. The main cable from the gun stand is also brought through this same opening. The seven-prong plug on the main cable is inserted in the seven-contact socket which is on the left side of the Amplifier-Controller unit and near the front.

Caution: It is generally good practice on any electrical equipment with which the public comes in contact to have it thoroughly grounded to a cold water pipe. For this purpose, a ground terminal is provided on the front of the Amplifier-Controller Chassis. A heavy stranded wire lead may run

from this point to any good earth ground, such as is provided by a cold water pipe. A standard clamp for the water pipe may be obtained from any radio supply store.

The shooting distance most generally employed is about twenty-five feet, although fifty feet of cable is supplied. This cable should not be shortened or lengthened, because the voltage on the gun lamp will be affected.

The location of the target cabinet in the room is very important. Do not have the cabinet facing large windows, mirrors reflecting bright lights or flood lights. If too much light falls upon the cabinet and target, the photo cell does not respond to the light of the gun lamp.

Remember: Do not have the target cabinet facing large windows, floodlights or mirrors reflecting bright lights.

OPERATION AND MAINTENANCE

TARGET

The target is a hollow figure, supported on a shaft, having a single photo cell with three lenses, one on each side and one in the "belly." Inside the head of the figure is a small lamp to illuminate the eyes and mouth. As a hit is made, the motor is reversed and the chain moves in the opposite direction. This causes the cylindrical cam on the carriage to rotate, lifting the target. As the target lifts, a switch on the carriage closes, lighting the eyes and mouth of the figure. As the figure turns, a slight pause will be noted when the figure is in the upright position (at the mid point of the turn). The figure continues turning and drops to the running position, facing opposite to the original direction. When the cylindrical cam stops rotating the carriage moves in the direction of the chain.

MOTOR

The motor is of the capacitor type for reversing service. The reversing is controlled through a reversing relay on the Amplifier-Controller Unit. See paragraph on Lubrication.

LIMIT SWITCH

After the last shot, the play control relay drops out, rendering the Amplifier-Controller inactive. The motor continues to operate until the target carriage depresses the limit switch lever, stopping the motor. This keeps the target in full view when not being operated.

AMPLIFIER-CONTROLLER

The amplifier-controller contains the amplifier and relay and stepper assemblies. The amplifier operates the thyatron tube (2050) which, in turn, operates the score stepper. The shot counter stepper is operated by a timing relay in gun stand. Two pairs of contacts, C & D, on the armature of the shot counter close each time the shot counter stepper operates; one pair of contacts, D, closes the plate circuit to the thyatron which would allow the thyatron to operate only when a shot is made; the other pair of contacts, C, are carry-over contacts for the play control relay and keep it from falling out too quickly on the last shot, which would result in a poor light spot on the 20th shot from the gun.

On the front of the shot counter is a cam disc which opens the circuit, Contact B, to the play control relay on the 20th shot and, when reset to start, opens a switch, Contact A, to the credit motor in the gun stand, preventing operation of this credit motor as long as the shot counter is at start ("O") position.

The score counter stepper is operated by the thyatron tube (2050) when a hit is made. On the armature of the score stepper are two pairs of contacts, F & H, one pair, F, operates the "growler" and the other pair, H, is a carry-over pair for the thyatron to give a full stroke to the stepper on a short duration hit.

On the front of the score counter stepper is a contact disc having three rows of contacts, J, K & L. The outer row, L, is for the individual score number; the center row, K, has contacts only from 12 to 20 inclusive. Contacts 12, 13, 14, 15 are wired together to illuminate the word "MARKSMAN"; 16, 17, 18 are wired together for "SHARP-SHOOTER"; 19 and 20 are wired to the "EXPERT."

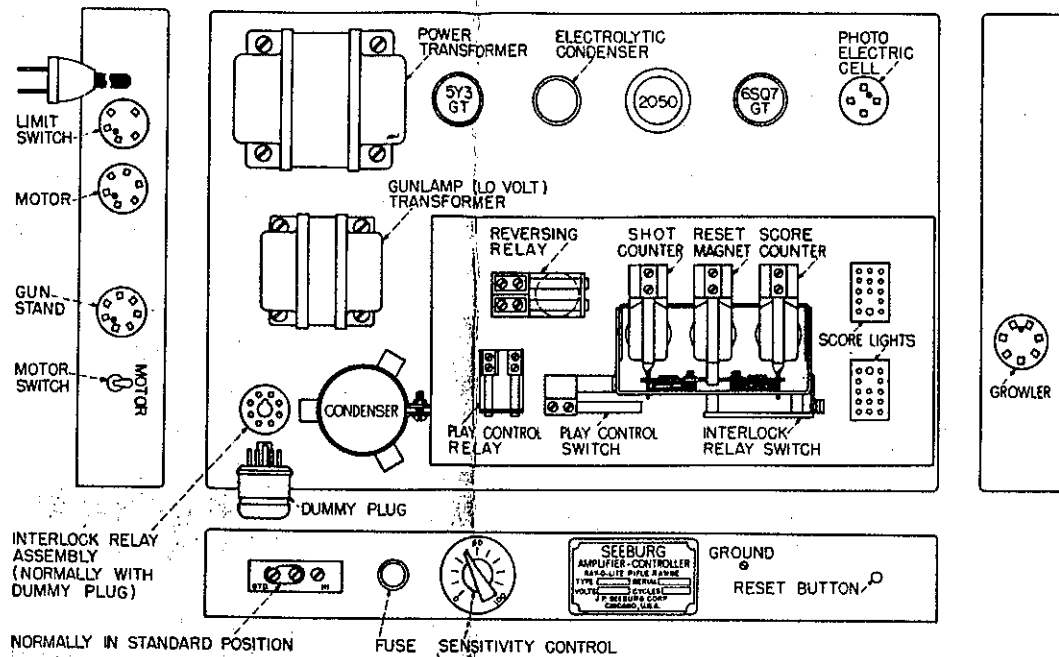

PARTS LOCATION - AMPLIFIER-CONTROLLER, TYPE AC1-L6

The inner row of contacts, J, has the contacts only at alternate positions to operate the reversing relay.

On the right side of this contact disc is a switch, M, which is closed at the 20th position. This switch operates the interlock relay assembly when the "Free Game" accessory is used.

Between the two steppers is the reset magnet which resets both steppers. This magnet is energized by a switch, EE, operated by the motor drive in Gun Stand. On the armature of the reset magnet is a pair of normally closed contacts, E, in series with the play control relay. This keeps the gun from being operated during the reset period.

PLAY CONTROL RELAY

The play control relay, Contacts T, U, V, W & Z, controls the motor and gun lamp transformer, as well as the D.C. supply to the gun trigger.

MOTOR REVERSING RELAY

The motor reversing relay, Contacts P, Q, R, & S, is used to change motor and chain direction thereby causing the target to stand up and turn around. This relay is operated by the center contact finger on the score counter contact plate.

MANUAL RESET

On the Amplifier-Controller Unit, to the right, is a manual reset button for resetting both steppers and starting game in operation without depositing a coin.

GUN LAMP VOLTAGE

On the Amplifier-Controller Unit, to the left, is a gun lamp voltage control panel. It is normally set on the standard position, marked "STD." Should low line voltage be encountered and the light from the gun lamp be insufficient, the link can be changed to the "HI" position, which will raise the voltage to the gun lamp.

Caution: Do not move the link to the "HI" position unless the line voltage is KNOWN to be low, as the life of the gun lamp will be shortened by using it on "HI" position with normal line.

COIN MECHANISM

The action of either coin slide operates a two-circuit toggle switch, SW2 & 3. When the single game coin slide is pushed all the way in, the circuit is closed to the single credit solenoid coil, RY6. This single credit solenoid, RY6, actuates the six-blade credit switch, SW5, that will be cancelled after one game has been started. When the multiple

game coin slide is pushed all of the way in, the circuit is closed to the multiple credit solenoid coil, RY7. This multiple credit solenoid, RY7, actuates the six-blade credit switch, SW5, that will be cancelled after the third or sixth game has been started. Either slide-operated toggle switch also opens the start button switch, SW7, so that a game *cannot be started* until the coin slide has been pulled all the way out. Each game must be started by pushing the start button, SW7. The green jewel light, PL2, remains on as long as there is a credit on the mechanism. This credit must be used before another coin is inserted or some credit may be lost. The amber jewel light, PL1, remains on only while a game is in progress.

The action of either coin slide also operates a coin counter which registers the number of times a coin has been accepted. Separate counters are installed on each coin slide.

MUZZLE BLAST SOUNDER

Fastened to the inside of the gun stand is a solenoid, RY9, which simulates the muzzle blast effect of the gun. This solenoid operates each time the trigger is pulled. A muzzle blast sounder pad, Part No. 125208 is furnished in the key bag of each gun stand assembly. If the blast from the sounder is too loud, take out the sounder mounting screws, place this pad under the sounder and re-mount the sounder with the screws.

SHOT TIMING POTENTIOMETER

There is a shot timing potentiometer mounted on the Credit & Relay Assembly chassis in the gun stand. This potentiometer, designated as R31 on the schematic diagram, is connected across the coil of the shot timing relay. It is adjusted at the factory to give a gun lamp light pulse .10 - .13 seconds long. Turning the potentiometer arm clockwise lengthens the light pulse duration - a maximum length of approximately .20 seconds can be obtained.

GUN

The gun is connected to the gun stand by a five-conductor cable. The trigger mechanism is so designed that full pressure on the trigger will operate a single cycle double

throw switch, SW4. Releasing the pressure on the trigger allows the switch to assume a normal position and charge its timing condenser.

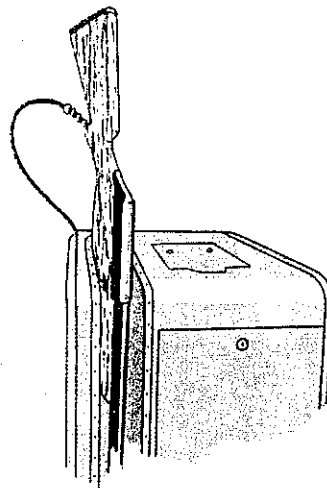

When not in use, the gun should be placed in the gun stand with the muzzle pointed down as shown.

GUN LAMP

The gun lamp is enclosed in a housing which clamps on the rear end of the gun barrel. It is important that the gun lamp be properly centered in the cartridge to give maximum light to operate the photo cell.

If it becomes necessary to adjust or replace a lamp, observe the following procedure:

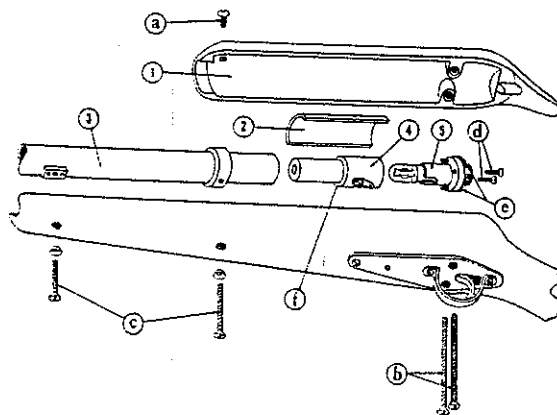

1. Remove rear sight from (1) by taking out screws (a) and (b).
2. Remove rubber pad (2).
3. Remove screws (c) holding gun barrel in stock and lift barrel and cartridge (3) from the stock.

4. Move gun barrel away from the lamp cartridge so the cartridge slips out of the barrel.
5. Remove the gun lamp socket (5) by removing screws (d). Do not take out screws (e).
6. Replace the gun lamp. Reassembly the lamp cartridge and barrel. Fasten the barrel in the gun stock with the cartridge in the barrel so the shoulder (f) is against the end of the barrel.
7. It is important that the gun lamp is centered in the cartridge. If it is not, the light from the gun will be reduced and the pattern of the spot of light will be uneven. Test the centering by "shooting" at a white wall or piece of white cardboard about 20 feet from the end of the gun. The pattern should be round and of uniform brightness. If it is not, correct by adjusting the position of the screws (d) and (e) at the end of the cartridge. Tighten the screw on the side corresponding to the dark side of the light pattern (first loosening the screw on the opposite side).

The lamp cartridge should be seated firmly against the end of the gun barrel when checking the lamp centering.

8. After the lamp has been correctly centered, place the rubber pad (2) over the cartridge and gun barrel and reassemble the rear sight frame (1).

The muzzle lens assembly is located in the front end of the gun barrel. To remove lens, loosen the front screw on the gun sight, which will allow the lens to be removed by inserting a finger and twisting while pulling out. After replacing the lens, be sure it is pushed against its stop and then tighten screw. It is very important that the muzzle lens and the small cartridge lens be kept clean and that the gun lamp is properly centered.

LOCKS

There are two sets of locks; the locks on the target cabinet and door of the gun stand are alike and operated by the same key. The cash box in the gun stand has a different lock, operated by a separate key.

GROWLER

Each time a hit is obtained and the score advanced, a pair of contacts, F, on the score stepper close and operate the electronic "growler" to simulate the bear's growl. The "growler" consists of a neon lamp, a 6V6GT tube, and operates a small speaker. Power to operate the "growler" is obtained from the Amplifier-Controller Unit by means of the plug on the right side of the Amplifier-Controller Unit. As shipped from the factory, the Growler volume is normally set on "HI" at the output control panel. In case this setting is too loud, the link may be switched to "SID."

LUBRICATION

It is important that the target motor (M4) be oiled at regular intervals with SAE#10 motor oil. The oil cup for the lower bearing should be filled, and the oil pad at the top bearing be saturated with oil. On the target carriage, all gears should be lubricated with lubriplate, and all shafts and rollers oiled with SAE#10 motor oil. The rail contact roller pins should be lubricated with one drop of "Oil-Dag" (graphite + SAE#10 motor oil).

All bearings of the credit motor (M3) in the gun stand should be oiled with SAE#10 oil every six months. Only a drop or two of oil are necessary. The same applies to the associated gear train.

See Lubrication Chart mounted on back of scenery of front door.

★ ★ ★

NOTICE

THE J. P. SEEBURG CORPORATION reserves the right to make any changes or improvements in its products without notice and without obligation to subsequent purchasers, and without being required to make corresponding changes or improvements in products theretofore manufactured or sold.

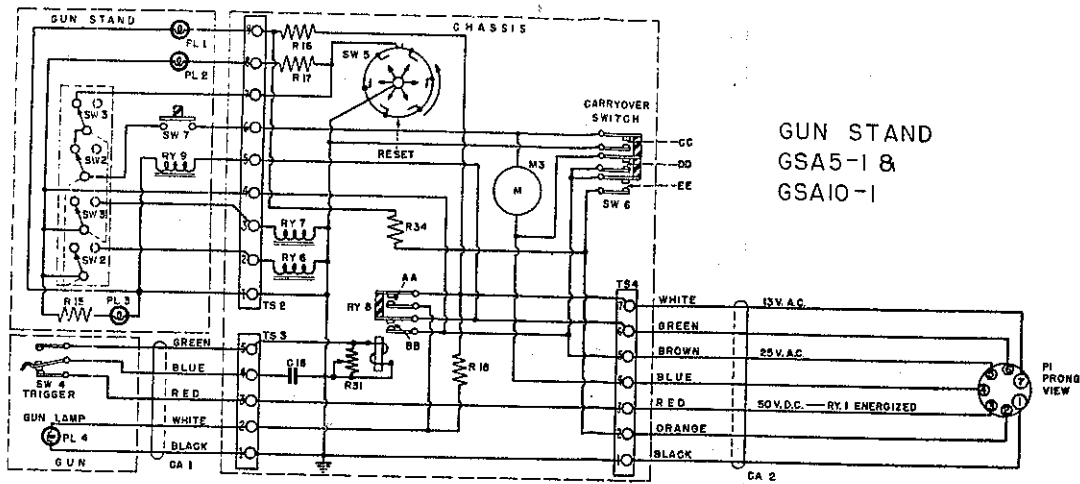

GUN STAND
GSA5-1 &
GSA10-1

PARTS LIST

Item	Part No.	Description	Item	Part No.	Description	Item	Part No.	Description
C1	85019	500 mfd Mica Condenser	P1	S21117	7-Prong Plug	R28	82766	330 ohm 1 w. Resistor
C2	85019	500 mfd Mica Condenser	P2	S21044	4-Prong Plug	R29	82446	68,000 ohm 1/2 w. Resistor
C3	85016	2000 mfd Mica Condenser	P3	65319	6-Prong Plug	R30	82417	270 ohm 1/2 w. Resistor
C4	86043	.25 mfd 200 v. Condenser	P4	F200241	5-Prong Plug	R31	125201	500 ohm Potentiometer
C5	86031	.02 mfd 400 v. Condenser	P5	306038	Dummy Plug Assembly (Octal)	R32	82691	200,000 ohm 1/2 w. Resistor
C6	86155	.1 mfd 600 v. Condenser	P6	402041	7-Prong Plug	R33	82436	10,000 ohm 1/2 w. Resistor
C7	87587	200 mfd 50 v. Electrolytic	P7	125632	14 Contact Plug	R34	81135	70 ohm 5 w. Resistor
C8	87586	10 mfd 300 v. N.P. Electrolytic	P8	125632	14 Contact Plug	RY1	306020	Play Control Relay
C9a	87528	20 mfd 400 v. Electrolytic	P9	303113	Line Cord & Plug Assembly	RY2	306019	Reversing Relay
C9b	87528	30 mfd 400 v. Electrolytic	P10	F402066	2-Prong Plug	RY3	306041	Shot Step Relay
C10	86171	2.4 mfd Oil Condenser used only with 4-lead Motor #A250250	P11	F402781	Plug & Line Assembly	RY4	306043	Pawl Reset Magnet
		1. mfd Oil Condenser used only with 6-lead Motor #A250109	P12	10895	2-Prong Plug	RY5	306042	Score Step Relay
		2.3 mfd Oil Condenser used only with 6-lead Motor #A250109	PL1	10242	#51 Lamp	RY6	505082	Single Credit Coil
		2.3 mfd Oil Condenser used only with 6-lead Motor #A250109	PL2	10242	#51 Lamp	RY7	505082	Multiple Credit Coil
C11	86155	.1 mfd 600 v. Condenser	PL3	10242	#51 Lamp	RY8	125141	Shot Timing Relay
C13	86155	.1 mfd 600 v. Condenser	PL4	585	Gun Lamp	RY9	125150	Muzzle Blast Sounder
C14	86155	.1 mfd 600 v. Condenser	PL5	10242	#51 Target Lamp	S1	84282	7 Contact Socket
C15	87568	20 mfd 25 v. Electrolytic	PL6	505173	#55 Corner Lamp	S2	84227	4 Contact Socket
C16	87587	200 mfd 50 v. Electrolytic	PL7	10242	#51 Marksman Lamp	S3	84223	6 Contact Socket
C18a	87590	30 mfd 350 v. Electrolytic	PL8	10242	#51 Sharpshooter Lamp	S4	84283	5 Contact Socket
C18b	87590	10 mfd 350 v. Electrolytic	PL9	10242	#51 Expert Lamp	S5	84220	8 Contact Socket
C19	86043	.25 mfd 200 v. Condenser	PL10	10242	#51 Score Lamp	S6	84265	7 Contact Socket, Lg.
C20	86001	.002 mfd 400 v. Condenser	R1	82924	10 meg 1/4 w. Resistor	S7	306014	14 Contact Socket
C21	86160	.005 mfd 200 v. Condenser	R2	82456	.47 meg 1/2 w. Resistor	S8	306014	14 Contact Socket
C22	86155	.1 mfd 600 v. Condenser	R3	82924	10 meg 1/4 w. Resistor	S9	F402253	AC Outlet
C23	86043	.25 mfd 200 v. Condenser	R4	82428	2200 ohm 1/2 w. Resistor	S10	301019	2 Contact Socket
CA1	S21017	5 Conductor Cable	R5	82454	330,000 ohm 1/2 w. Resistor	SP1	125663	Speaker
CA2	S21116	7 Conductor Cable	R6	82436	10,000 ohm 1/2 w. Resistor	SW1	306013	Manual Reset Switch
CA3	A250246	2 Conductor Cable (Shield Wire)	R7	82460	1 meg 1/2 w. Resistor	SW2,3	125122	Toggle Switch
CA4	125450	3 Conductor Cable	R8	82417	270 ohm 1/2 w. Resistor	SW4	S21010	Trigger Switch
CA5	125631	27 Conductor Cable Assembly	R9	82400	10 ohm 1/2 w. Resistor	SW5	504140	Credit Switch
CA6	306096	5 Conductor Cable	R10	81024	200 ohm W.W., 5 w. Resistor	SW6	125121	Carry-over Switch
F1	602411	5 amp. Fuse	R11	81019	6600 ohm W.W., 5 w. Resistor	SW7	12105	Start Button
L1	S21261	R.F. Choke	R12	81134	3000 ohm W.W., 5 w. Resistor	SW8	S21168	Main Toggle Switch
L2	306017	Filter Choke	R13	306018	100,000 ohm Sensitivity Control	SW9	125390	Lamp Switch
LA1	125633	10 w. Cabinet Lamp	R14	82452	220,000 ohm 1/2 w. Resistor	SW10a	125410	Rail Contactor
LA2	125672	15 w. Cabinet Lamp	R15	81126	100 ohm 5 w. Resistor	SW10b	125410	Rail Contactor
LA3	306097	Neon Glow Lamp (NE48)	R16	81131	35 ohm 5 w. Resistor	SW11	125442	Limit Switch
M1	306001	Step Switch & R. Assembly	R17	81126	100 ohm 5 w. Resistor	SW12	306053	Interlock Relay Switch
M2	306023	Step Switch Assembly	R18	81021	11 ohm 25 w. Resistor	SW13	S21168	Motor Switch
M3	125135	Motor, Credit	R20	81132	22 ohm W.W., 5 w. Resistor	T1	306016	Power Transformer
M4	A250250	Motor Assembly, 4-lead, used only with #86171 Oil Condenser	R21	81129	115 ohm W.W., 10 w. Resistor	T2	306015	Lo-Volt Transformer
		Motor Assembly, 6-lead, used only with #303081 Oil Condenser	R22	82442	33,000 ohm 1/2 w. Resistor	T3	125664	Output Transformer
			R23	82460	1 meg 1/2 w. Resistor	TS1	306012	Terminal Strip
			R24	82467	3.9 meg 1/2 w. Resistor	TS2	125145	9 Lug Terminal Strip
			R25	82464	2.2 meg 1/2 w. Resistor	TS3	125144	5 Lug Terminal Strip
			R26	82456	470,000 ohm 1/2 w. Resistor	TS4	125142	7 Lug Terminal Strip
			R27	82456	470,000 ohm 1/2 w. Resistor	TS5	306012	3 Screw Terminal Strip

MECHANICAL PARTS LIST ON PAGE 8

AMPLIFIER - CONTROLLER AC 1 - L6

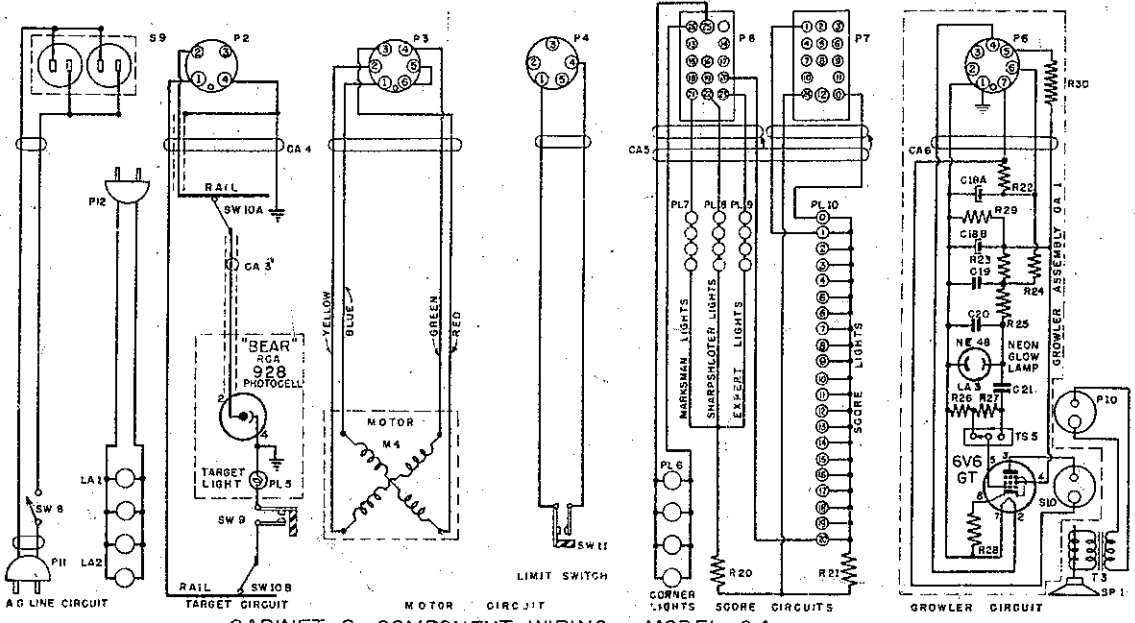
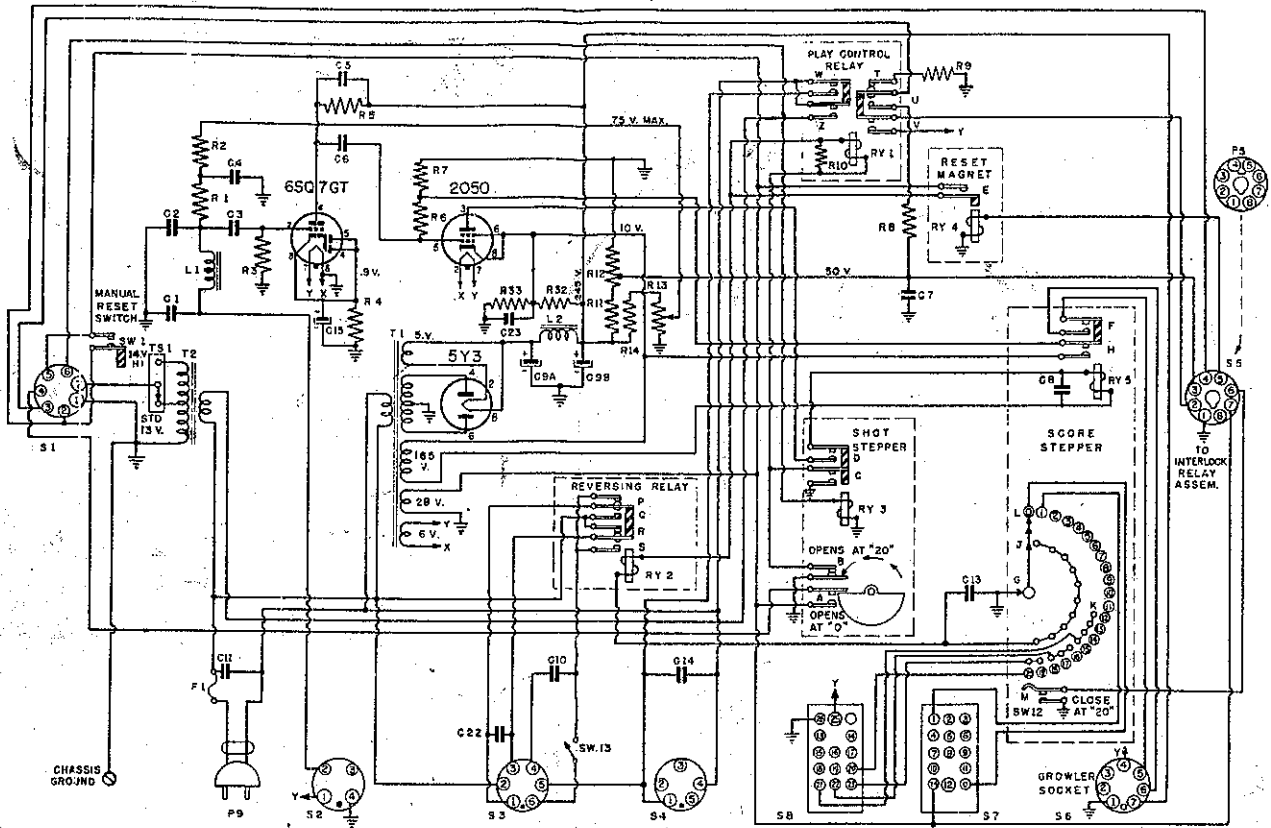

CABINET & COMPONENT WIRING MODEL G4

WARRANTY

J. P. Seeburg Corporation warrants this instrument, manufactured by it, to be free from defects in material or workmanship under normal use. Our obligation under this warranty is limited to making good at our factory any part or parts thereof which shall, within ninety days after delivery of such product to the original purchaser, be returned to us or to our authorized dealer or distributor from whom purchased with all transportation charges prepaid to our factory, and which our examination shall disclose to our satisfaction to have been thus defective.

This warranty does not extend (1) to any of our products which have been subject to misuse, neglect, accident, incorrect wiring not our own, improper installation, or to use in violation of instructions furnished by us, (2) to units which have been repaired or altered outside of our factory, (3) to cases where the serial number of the product has been removed, defaced or changed, (4) to tubes or lamps, or (5) to accessories not of our own manufacture used with our products.

Any part found by us to be defective will be exchanged by the authorized dealer or distributor without charge to the owner.

This warranty applies only to our products which are used within the continental limits of the United States of America and is in lieu of all other warranties expressed or implied, and no representative or person is authorized to assume for us any other liability in connection with the sale of our products.

MECHANICAL PARTS LIST

RAIL ASSEMBLY

Part No.	Description
125418	Bottom Rail
125419	Top Rail
125425	Chain
125493	Contact Rail Assembly
125415	Contact Rail
125422	Insulator Plate
125423	Contact Rail Mounting Bracket
125544	Bearing Bracket, Shaft & Sprocket Assembly (Drive)
125545	Bearing Bracket, Shaft & Sprocket Assembly (Idler)
125483	Bearing Bracket & Bushing Assembly
125486	Drive Shaft and Pin Assembly
125431	Shaft (Idler)
125424	Sprocket
80107	Roll Pin
125449	Retaining Ring
125444	Intermediate Pulley Bearing Assembly
125485	Intermediate Dual Pulley Assembly
125467	Motor Drive Pulley Assembly
125441	Drive Belt
125434	Pulley (Large)
250251	Motor
250111	Motor Clamps
250108	Support Plug (Rubber)
78029	Rubber Grommets (Mounting)
125440	Grommet Sleeve
125465	Limit Switch Lever & Hinge Assembly
125427	Limit Switch Insulator
125462	Limit Switch Compression Spring
125438	Limit Switch Hinge Rod
125448	Retainer Rings
125442	Limit Switch

AUXILIARY CARRIAGE (DOG) ASSEMBLY

Part No.	Description
125499	Carriage Skid Shoe Assembly
125402	Carriage Skid Shoe Retaining Ring
125398	Swivel Bracket Assembly
229220	Swivel Roller Retaining Ring
125389	Carriage Shaft (Auxiliary)
125452	Shaft Retaining Ring
125399	Clutch Assembly (Auxiliary)
125572	Detent Spring
71949	Detent Adj. Screw
70153	Nut
125559	Support & Figure Assembly, complete
125491	Auxiliary Figure Support Assembly
125494	Auxiliary Figure Assembly
125308	Auxiliary Figure (Dog)
125306	Spring (Coil)
125548	Trip Wire, Right Hand
125549	Trip Wire, Left Hand
125571	Restoring Spring
125459	Tail Spring
125547	Hinge Pin
125448	Retaining Washers
125468	Chain Retainer Bracket Assembly
125542	Chain Retainer Assembly
231163	Retaining Ring

AMPLIFIER CONTROLLER, ACI-16

Part No.	Description
10832	Electrolytic Mtg. Plate
300061	Fuse Receptacle
306011	Sensitivity Escutcheon
300076	Bar Knob
303086	Clamp, Motor Condenser
11358	3 Lug Terminal Strip
11040	4 Lug Terminal Strip
10085	3 Lug Terminal Strip
10069	3 Lug Terminal Strip

CARRIAGE TARGET (BEAR) ASSEMBLY

Part No.	Description
125337	Cylindrical Cam Shaft
125330	Carriage Roller
125329	Carriage Roller Stud
125338	Clutch Shaft
125484	Clutch Assembly
125376	Idler Gear
125535	Cam Lever Assembly
125340	Idler Gear Stud
H20513	Ball Bearing Retainer Assembly
125333	Cylindrical Cam
125452	Retaining Ring
125367	Lift Fork Bracket
125482	Lift Fork Assembly
125330	Lift Fork Roller
125402	Retaining Ring
125319	Lift Fork Shaft
125410	Rail Contact Spring Assembly
125577	Target Shaft, Gear & Bracket Assembly
125463	Intermittent Gear & Shaft Assembly
80104	Drive-Lok Pin
125357	Lift Collar
72264	Washer, Steel
72270	Cushion Washer, Rubber
125576	Target Hinge, Bushing & Connector Assembly
125398	Swivel Bracket Assembly
125403	Retaining Ring
125408	Chain Retainer Bracket Assembly
125442	Chain Retainer Assembly
231163	Retaining Ring
125536	Latch & Bracket Assembly
125322	Limit Switch Shoe
125390	Lamp Switch (Head)
125407	Target Bracket Assembly, complete
125536	Front Leg Connector
125350	Rear Leg Connector
125469	Lift Collar Link Assembly
84284	Socket (P.C.)
125539	Photo Cell, RCA #928
250246	Photo Cell Light Shield
74112	Terminal
125567	Target Body (Right)
125568	Target Body (Left)
21085	Target Lens
125569	Target Head Assembly
125563	Rear Leg Assembly (Left)
125564	Rear Leg Assembly (Right)
125565	Front Leg Assembly (Left)
125566	Front Leg Assembly (Right)
125478	Leg Trip Wire
125537	Lamp Socket
10242	Lamp #51
125355	Front Leg Screw
125347	Hinge Pivot (Rear Leg)
125358	Lift Collar Screw
125457	Spring, Counter Balance
125458	Spring, Over-center

TARGET CABINET AUXILIARY PARTS

Part No.	Description
125619	Cabinet
125653	Cabinet Leg, Right Hand
125654	Cabinet Leg, Left Hand
125623	Door Glass
125624	Door Lock Assembly
400132	Score Light Socket
125616	Score Light Glass
125644	Score Strip Bullseye
125615	Score Rating Glass
404165	Cabinet Lamp Socket
125635	Door Scenery

TARGET CABINET AUXILIARY PARTS (cont.)

Part No.	Description
125636	Side Scenery, Right Hand
125637	Side Scenery, Left Hand
125638	Rear Scenery
125642	Center Scenery
125661	Leg Actuator Springs
125550	Dog Actuator Bar
125668	Cabinet Wall Bracket, Wall Model only
125671	Plastic Sign
125687	Wall Mtg. Kit
125686	Mounting Bracket
125694	Lubrication Chart

GSA 5-1 GUN STAND

Part No.	Description
125100	Gun Stand & Gun Assembly
125125	Gun Stand
125624	Lock Assembly
S21122	Coin & Cigar Holder Back Plate
S21111	Coin & Cigar Holder
125151	Gun Holster
125192	Gun Holster Support Bracket
125161	Pilot Light & Jewel Assembly
125163	Coin Box Housing Assembly
125178	Coin Box Assembly
F401011	Coin Box Lock
125157	5c ABT "Ace" Coin Slide
125159	25c ABT "Ace" Coin Slide
F200118	Coin Counter
125110	Jewel & Socket Assembly, Amber
125111	Jewel & Socket Assembly, Green
125107	Credit & Relay Assembly
505070	Brush Assembly
505083	Solenoid Plunger Assembly
125137	Switch Operating Lever Assembly
500037	Shoulder Screw
500082	Button Release Lever End
125138	Carry-over Switch Spring
125185	Nameplate, 5c
125194	Cable Insulator
125187	Target Cable Assembly
S21117	7-Prong Plug
125108	Gun Assembly
S21846	Gun Stock Assembly
S21847	Cable Relief Spring Assembly
S21848	Gun Barrel Assembly
S21850	Cartridge Assembly
125204	Gun Barrel Assembly
125207	Cartridge Assembly
S80	Muzzle Lens Assembly
S108	Gun Cable Clamp
S21851	Lamp Socket Assembly
S85	Gun Lamp
S21051	Gun Sight Frame
S21852	Trigger Assembly
S21855	Terminal Strip Assembly
S70	Trigger Plunger Spring
S21854	Trigger Lever Assembly
S21004	Trigger Lever
125152	Trigger Trip Pawl
S55	Trigger Trip Pawl Spring
S51	Trigger
S21006	Trigger Pawl Plate
S82	Trigger Guard
125208	Sounder Pad

GSA 10-1 GUN STAND

Part No.	Description
125101	Gun Stand & Gun Assembly
125158	10c ABT "Ace" Coin Slide
125186	Nameplate, 10c